

NORTH

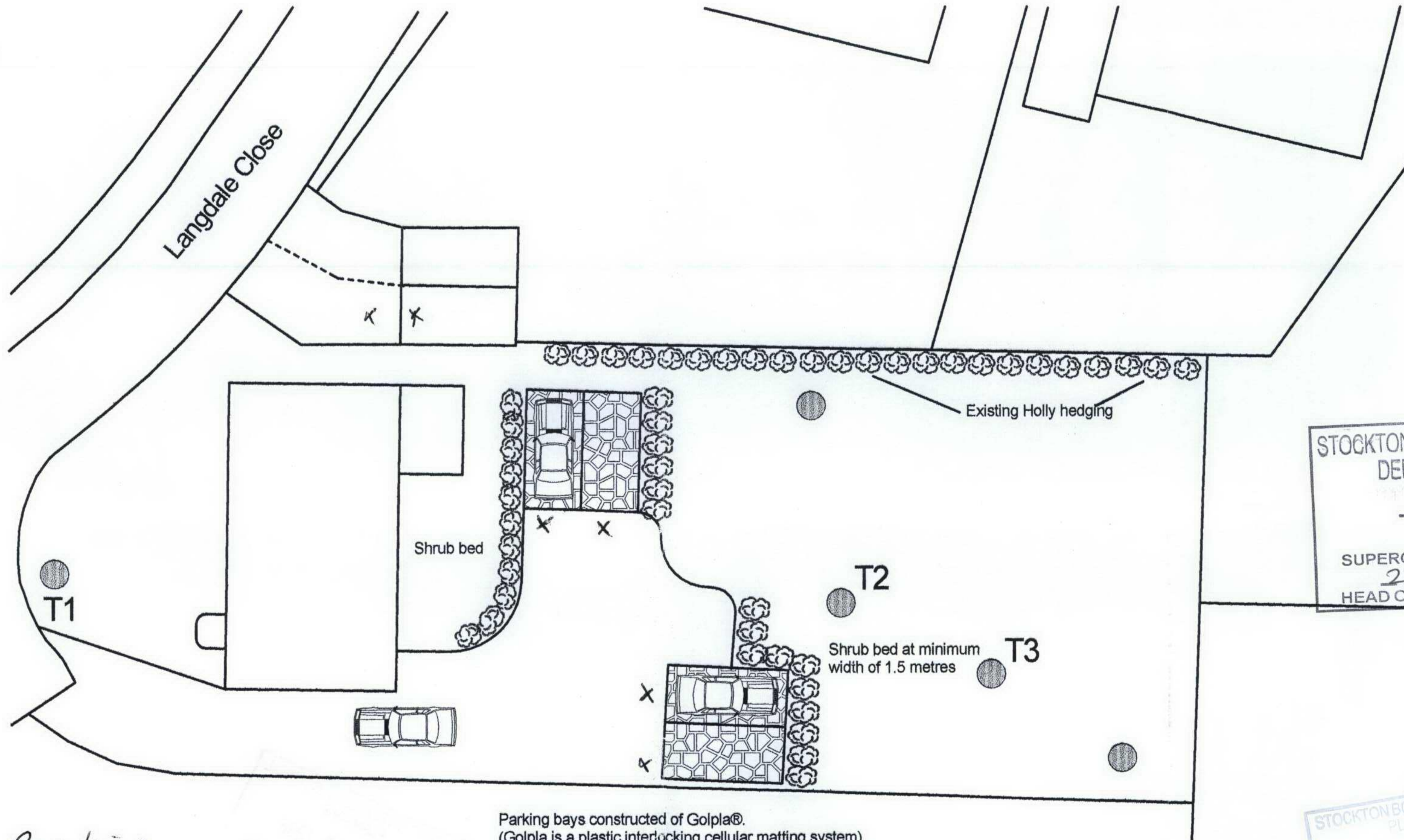
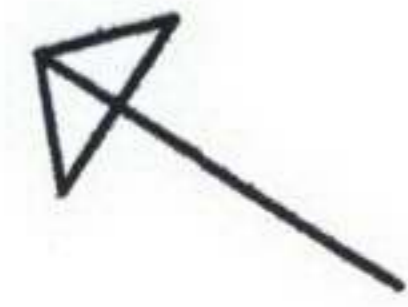

X = parking.

Parking bays constructed of Golpla®.  
 (Golpla is a plastic interlocking cellular matting system)  
 Golpla to be filled with porous loose gravel, to maintain  
 drainage as well as preventing compaction and migration.  
 On 150mm of type 1 sub base. All excavation within the  
 branch spread to be hand dug.

STOCKTON BOROUGH COUNCIL  
 DEPOSITED PLAN  
 - 7 APR 2006  
 SUPERCEDES PLAN DATED  
 22.2.06 -  
 HEAD OF PLANNING & ENV.

SB001

STOCKTON BOROUGH COUNCIL  
 PLANNING  
 7 APR 2006  
 DATE RECEIVED

Proposed Parking Scheme  
 1 & 3 Langdale Close  
 Eggescliffe

Scale 1 : 200  
 Revised  
 Date 30/03/2006